



CLARKE NATIONAL
REALTY

- EST. 1953 -



30A Hinemoa Street PANANIA, NSW



3



1



2

SOLD BY LUCY CLARKE - 0407 919 408

If you are a first home buyer, looking to downsize or an investor this is simply ideal for you.

Some of the enticing features of this home include:

- An easy 600m walk to Panania Train Station and shops
- Brick veneer construction
- Brand new ducted air-conditioning unit
- A decent size L-shape lounge and dining room
- Great family size eat in kitchen plus a breakfast bar
- 3 sizeable bedrooms
- Neat and tidy bathroom
- Outdoor covered entertaining area
- Side lane access for extra parking
- Good quality security shutters
- Ducted vacuum

This home exudes natural sun light with a lot of great qualities and is a great opportunit



Lucy Clarke

0407 919 408

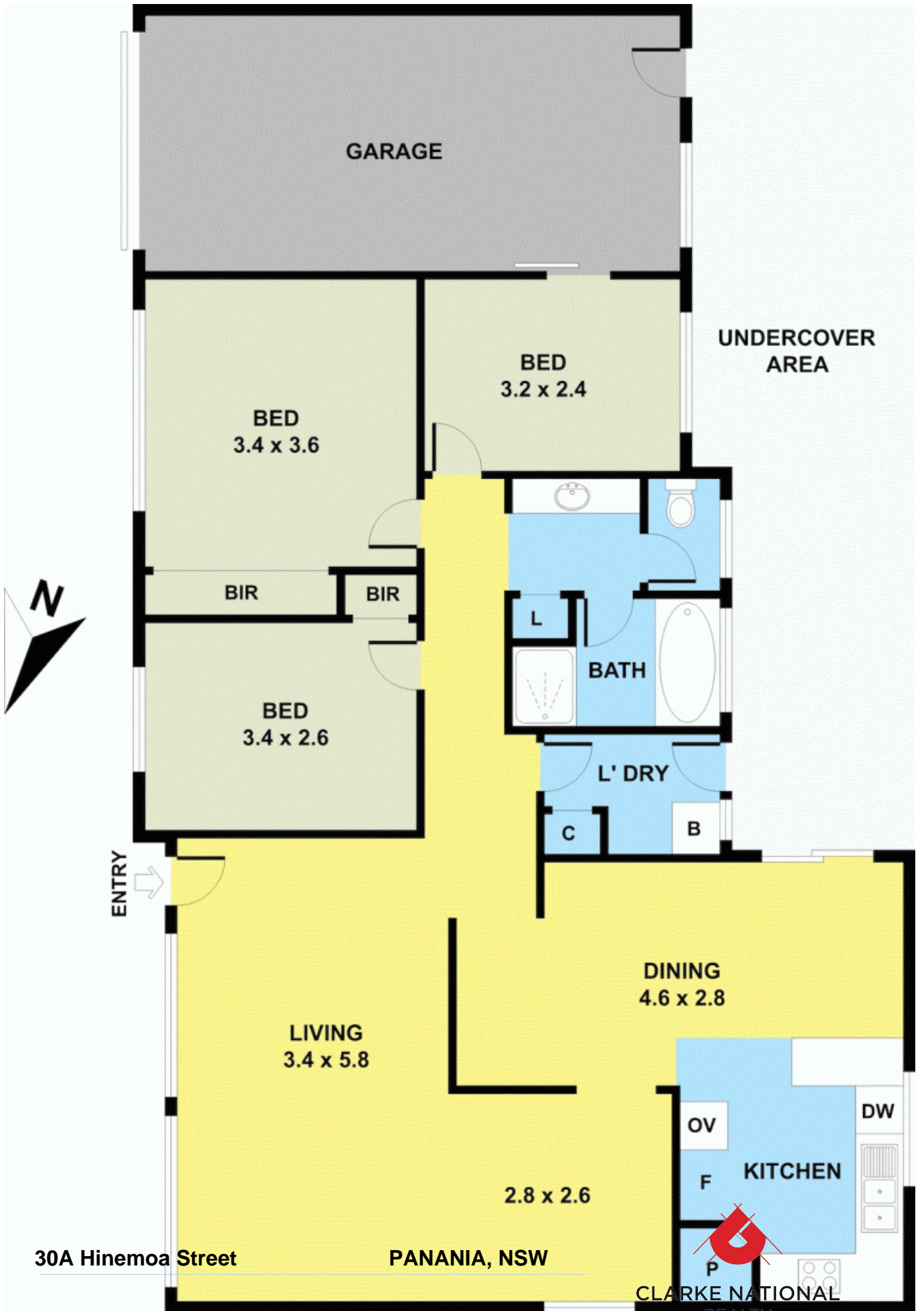

30A Hinemoa Street

PANANIA, NSW