



CLARKE NATIONAL
REALTY

- EST. 1953 -



35a Carew Street Padstow, NSW



5



4



2

A PIECE OF GREECE IN PADSTOW

A brand new Duplex with some of the nicest finishes the area has seen. Architecturally designed and ideally proportioned to exude its size, this home is perfect for young families, first home buyers and Investors - this is a must inspect to truly realise its quality of layout, size and pristine finishes.

Boasting:

- 5 generous size bedrooms with 1 located downstairs
- 2 bedrooms upstairs are accompanied with en-suites
- Master bedroom includes large walk in robe
- A main bathroom on each level of the home
- Open plan living, dining and kitchen that looks out to the sun-filled backyard
- Beautifully designed kitchen with bonus butlers pantry that offers an abundance of cupbo



James Clarke

0408 443 865

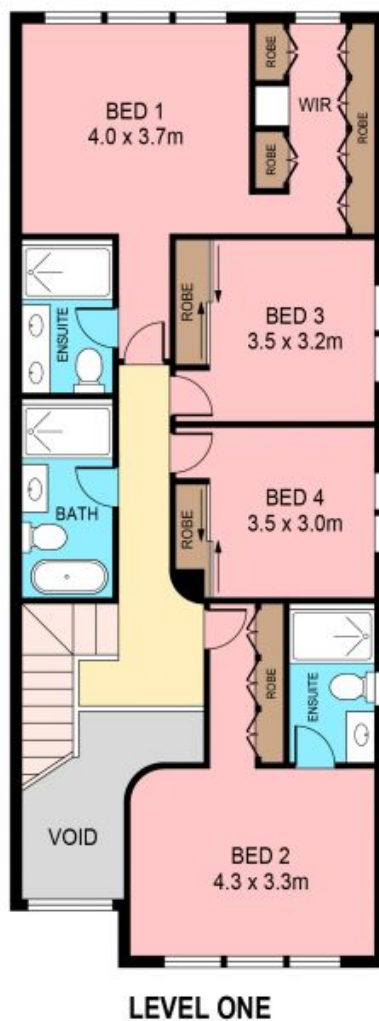
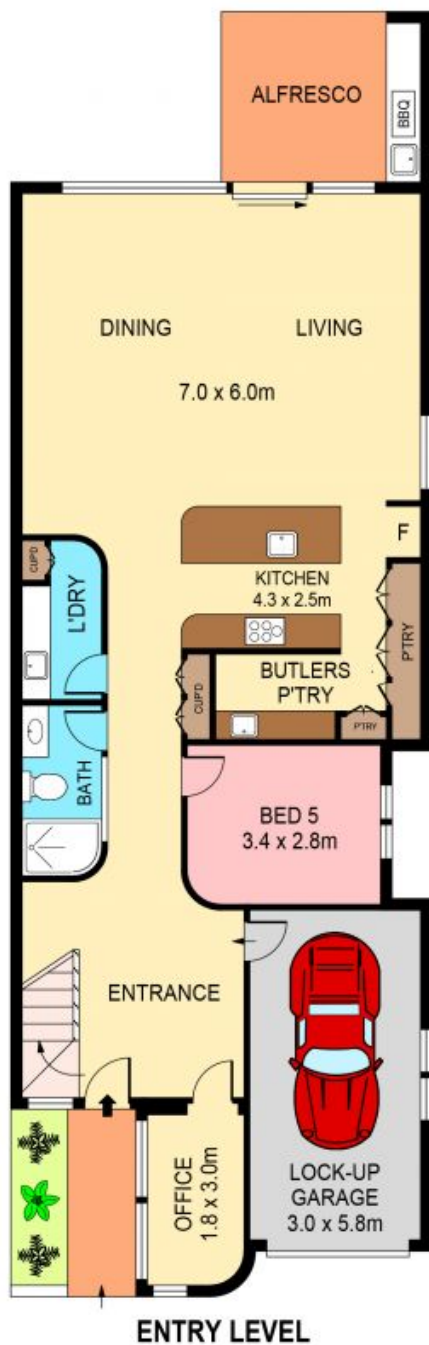

PLANS SHOWN ONLY INDICATIVE OF LAYOUT. DIMENSIONS ARE APPROXIMATE.
Ref. No: 103590



35A CAREW STREET
35a Carew Street

Padstow, NSW



CLARKE NATIONAL
REALTY

- EST. 1953 -