



CLARKE NATIONAL
REALTY

- EST. 1953 -



12 Ogilvie Street East Hills, NSW



575SQM - QUIET & CONVENIENT LOCATION

Introducing a fantastic opportunity for buyers sits this brick home set in a cul-de-sac street thats only moments to East Hills train station, Kelso Park South and Panania Diggers.

Ideal for any home buyer wanting to renovate or extend to their liking, Investors and builders wanting to build a duplex (S.T.C.A).

Featuring:

- 3 spacious bedrooms
- Tiled bathroom
- L-shape living and dining area with air-conditioning
- Sun-filled kitchen with electric cooking appliances
- Single lock up garage + workshop



James Clarke

0408 443 865

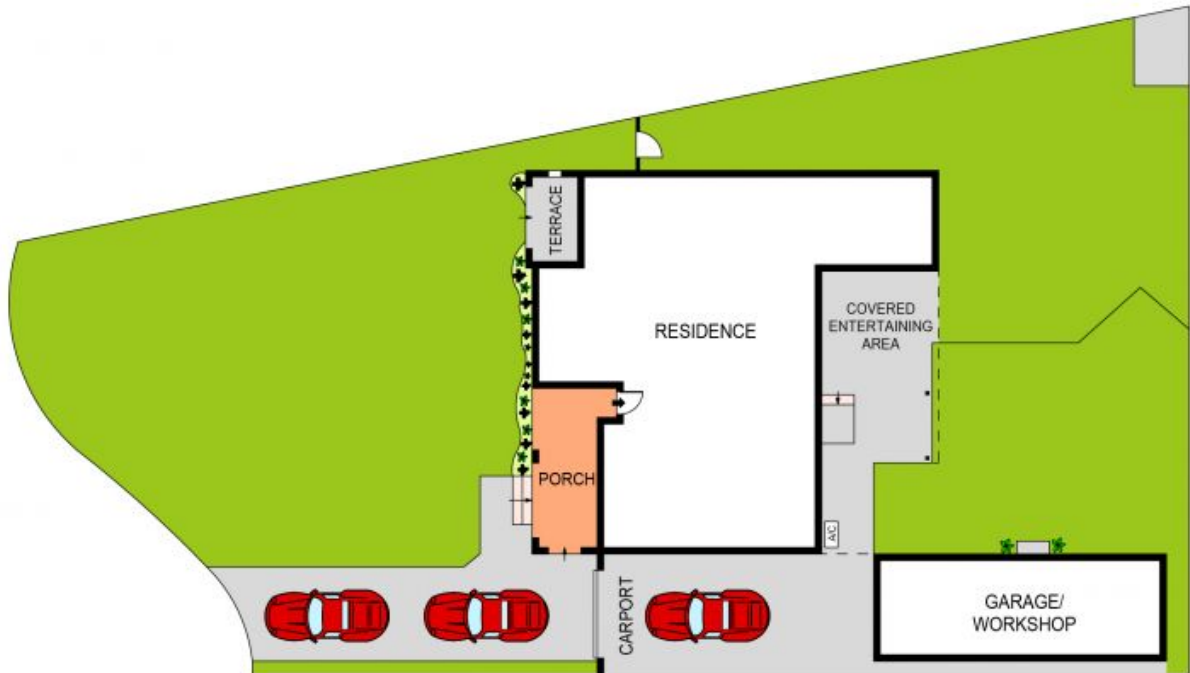

SITE PLAN
(NOT TO SCALE)

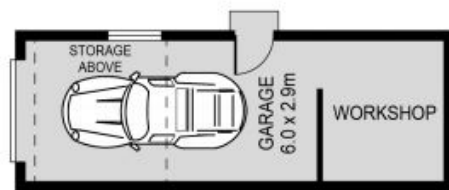

PLANS SHOWN ONLY INDICATIVE OF LAYOUT. DIMENSIONS ARE APPROXIMATE.
Ref. No. 104627



12 OGILVIE STREET
12 Ogilvie Street

East Hills, NSW



CLARKE NATIONAL
REALTY

- EST. 1953 -