



CLARKE NATIONAL  
REALTY

- EST. 1953 -



35 Stretham Avenue Picnic Point, NSW



3



1



2

## PICNIC POINT PEARLA

Located in one of the best positions in the area sits this family home located within the catchment area of the highly recommended Picnic Point Public School, walking distance to Picnic Point High School, local caf? and shops. This home is ideal for any young family wanting to buy in a great street and open to renovating to make it their own.

Featuring:

- 3 bedrooms with a very large master
- Fully tiled main bathroom with 2nd toilet off laundry
- Spacious living room
- Original kitchen with dining area
- Covered rear entertaining area
- Good size backyard for the kids



**James Clarke**

0408 443 865

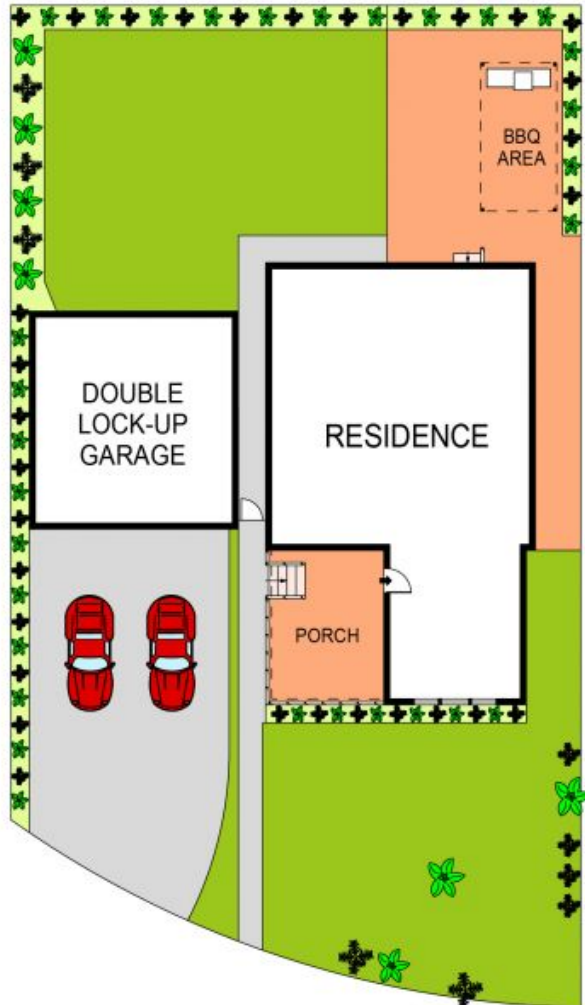
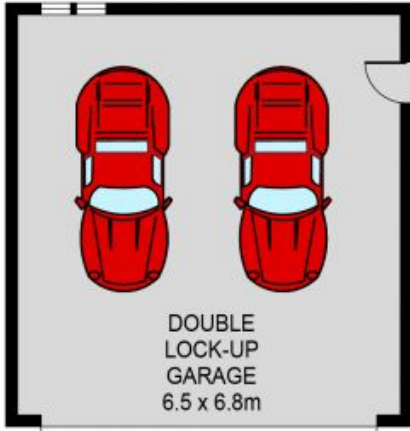

**SITE PLAN**  
(NOT TO SCALE)



PLANS SHOWN ONLY INDICATIVE OF LAYOUT. DIMENSIONS ARE APPROXIMATE.  
Ref. No: 106883



**35 STRETHAM AVENUE**  
**35 Stretham Avenue**

**Picnic Point, NSW**



**CLARKE NATIONAL  
REALTY**

- EST. 1953 -