



CLARKE NATIONAL
REALTY

- EST. 1953 -



66 Albert Street Revesby, NSW



4



2



2

MODERN & SPACIOUS FAMILY HOME IN GREAT LOCATION

Introducing this large and contemporary family home, ideally located in the heart of Revesby, walking distance to Revesby station, cafe's, restaurants and shops, this beautiful brick home is perfect for astute young families looking to upsize, Investors and any prospective buyer looking to purchase something large that has everything you need on the one level.

Boasting:

- 4 generous size bedrooms with master comprising of en-suite
- 2 bedrooms located upstairs, both with walk-in robes
- 2 separate living areas
- Fully tiled main bathroom
- Ample cupboard space and breakfast bar

Council Rates: \$425.45 p/q

Water Rates: \$173.00 p/q



James Clarke

0408 443 865

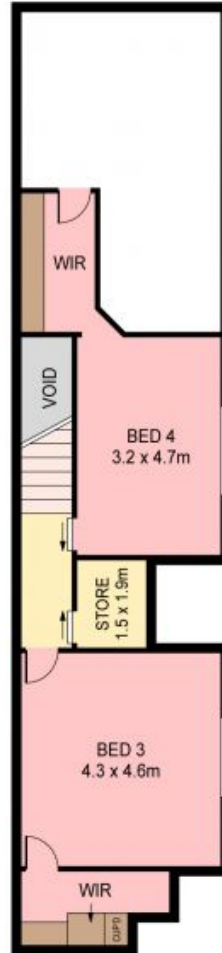

FIRST FLOOR

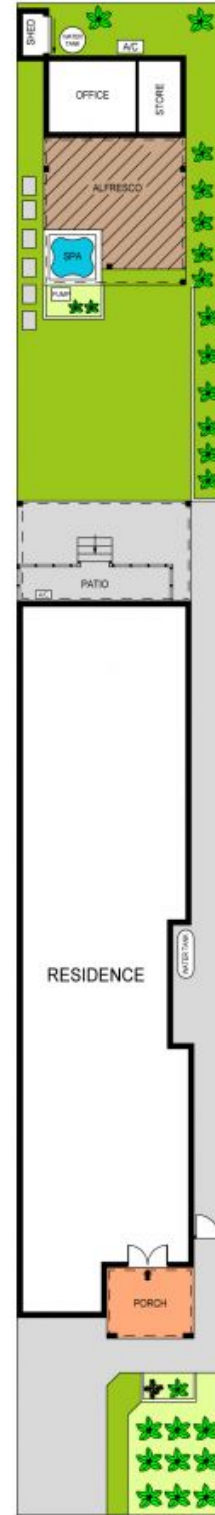

**SITE PLAN
(NOT TO SCALE)**

0 1 2 3 4 5 SCALE (METRES)

PLANS SHOWN ONLY INDICATIVE OF LAYOUT. DIMENSIONS ARE APPROXIMATE.
Ref. No: 108152



66 ALBERT STREET
66 Albert Street

Revesby, NSW



**CLARKE NATIONAL
REALTY**

- EST. 1953 -