



CLARKE NATIONAL
REALTY

- EST. 1953 -



55/169 Horsley Road Panania, NSW



WELL SOUGHT AFTER TOWNHOUSE

This very well maintained Townhouse, located in a quiet pocket at the rear of the complex is ideally suited to first home buyers looking to enter the market, Investors seeking great return on their investment and buyers looking to upsize from Apartment / Villa living.

Boasting:

- 2 decent size bedrooms, both with built-in robes + extra robe in master
- En-suite's in both bedrooms with bath in one
- 3rd toilet situated downstairs
- Spacious open plan living and dining area
- Modern Kitchen with gas cooking and stainless steel appliances
- Laundry with direct access to backyard
- Air-conditioning



James Clarke

0408 443 865



GROUND FLOOR

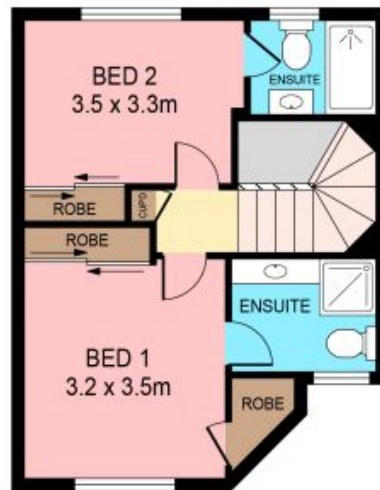

FIRST FLOOR



PLANS SHOWN ONLY INDICATIVE OF LAYOUT. DIMENSIONS ARE APPROXIMATE.
Ref. No. 108189

55/169 HORSLEY ROAD
55/169 Horsley Road

Panania, NSW



CLARKE NATIONAL
REALTY

- EST. 1953 -